

Overview

ARCHER series already showed their great potential in power demanding applications with their reasonable price. Over time, the ARCHER RGB 30000/40000 has made significant advancements and steadily evolved into a versatile product line with a wide range of applications. As we continue to expand this product line, our focus remains on understanding and meeting the unique demands of our customers.



Front Panel



Rear Panel



Front 45°



Rear 45°

Specifications

Light source

	<u>ARCHER RGB 30000</u>	<u>ARCHER RGB 40000</u>
Red :	8000 mw@638nm	10000 mw@638nm
Green :	10000 mW@529nm	13500 mW@529nm
Blue :	12000 mW@450nm	16500 mW@450nm

Beam Profile

	<u>ARCHER RGB 30000</u>	<u>ARCHER RGB 40000</u>
Beam Diameter (Projector Window) :	6.0mm * 7.5mm	7.5mm * 8.5mm
Divergence (Full angle) :	< 1.3mrad	< 1.3mrad
Modulation :	Analog 50KHZ	Analog 50KHZ
Laser Class :	Class IV	Class IV

Scanner

Galvo :	30kpps @ 8° ILDA test pattern
Scan Angle :	60° Max

Interfaces & Controls

Control :	ILDA in (Differential), ILDA out
Safety :	Key Switch, FDA Scan-safe Switch
Remote Interlock :	5 pins XLR
Scan Image Invert :	Invert-X, Invert-Y, Rotate 90°
Color adjustment :	Intensity R, G, B (0-100%)
Mains :	Neutrik PowerCon®

Optional Components

Embedded Controller :	Pangolin FB4 (upon request)
Scanner :	EMS 9000 35Kpps digital scanner (54°Max Angle)

Thermal Control

Cooling : Active Cooling/heating by TEC Peltier Elements
Ventilation : 40mm Low noise thermal-controlled fan * 8

Electric

Operating Voltage : AC 110V-240V
Power Consumption : 850W Max

Physical

L* W * H : 442mm* 374mm* 182mm (Without Yoke)
Weight : 28kg (Without Yoke)
Housing Materials : Black Anodized Aluminum
IP grade : IP52
Packaging : Flight case

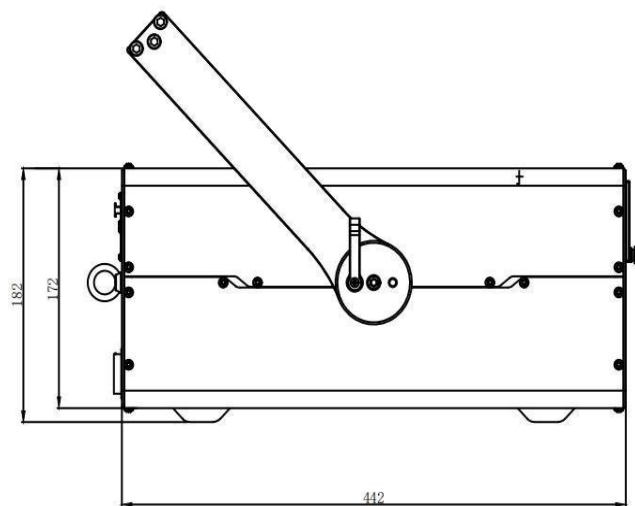
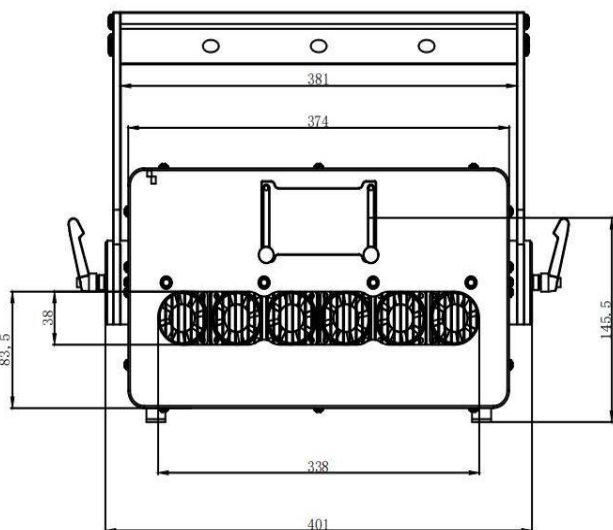

Compliance

Compliance FDA/CDRH, CE

Warranty

Warranty 24 months parts and labor

ABLE LASER TECHNOLOGY

3 Floor, Tower C, Huaming Industrial Park, Huanjiao Village, Shijing Town, Baiyun District, Guangzhou, China
TEL: +86 02 3639 7412 FAX: +86 02 3639 7413

www.able-laser.com
sales@able-laser.com